

Sug. Loaf - 118  
Luzerne.

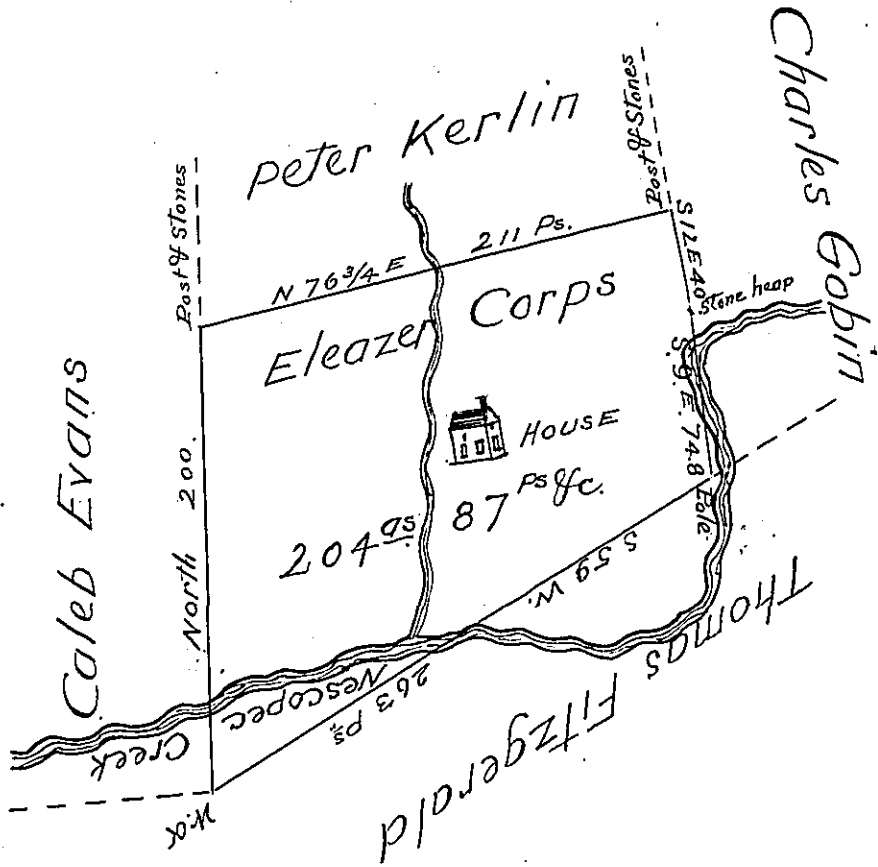

Draught of a tract of land situate in the Township of Sugar Loaf Luzerne County containing two hundred and four acres and eighty seven perches and the usual <sup>allowance</sup> of six per centum &c. Surveyed the above described tract of land for Eleazer Corps the 15<sup>th</sup> day of July A.D. 1817. By virtue of his warrant dated the 14<sup>th</sup> day of September A.D. 1815

John Bennet D.S.

To Jacob Spangler Esq<sup>r</sup> }  
Surv<sup>r</sup> Gen<sup>l</sup> }

N.B. Eleazer Corps and family reside upon the above described tract of land

John Bennet D.S.

IN TESTIMONY that the above is a copy of the original remaining on file in the Department of Internal Affairs of Pennsylvania, made conformably to an Act of Assembly approved the 16th day of February, 1833, I have hereunto set my Hand and caused the Seal of said Department to be affixed at Harrisburg, this eighteenth day of April 1904.

*Grace P. Benson*  
Secretary of Internal Affairs.